

Liner Bolt Removal Hammer

"Precision Relining Solutions with the PSDF Liner Bolt Removal Hammer: Enhancing Safety and Efficiency in Mining Operations"

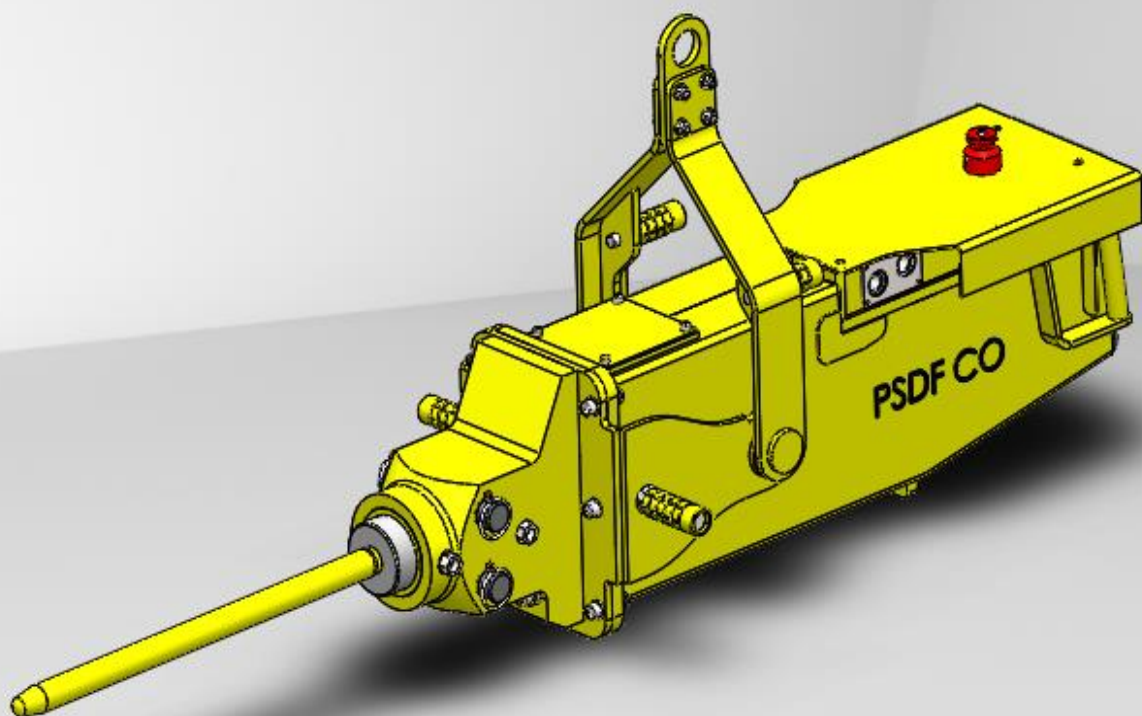

PSDF Co.

Liner Bolt Removal Hammer



At PSDF, we specialize in mill relining solutions designed to minimize downtime and boost productivity. The PSDF Liner Bolt Removal Hammer is expertly crafted to deliver powerful and controlled impacts, making it the ideal tool for removing tightly fastened liner bolts and large mill liners from SAG and Ball mills. With the right Liner Bolt Removal Hammer, you can significantly accelerate the relining process, reducing both time and costs, while ensuring a safer and more efficient operation.

Key Components of the PSDF Liner Bolt Removal System

The Hammer: Delivers powerful impact force to effectively remove liner bolts.

Hydraulic Power Unit: Provides a precise and controlled power to the hammer for optimal performance.

Suspension System: Ensures a stability and smooth operation, enhancing safety and efficiency during use.

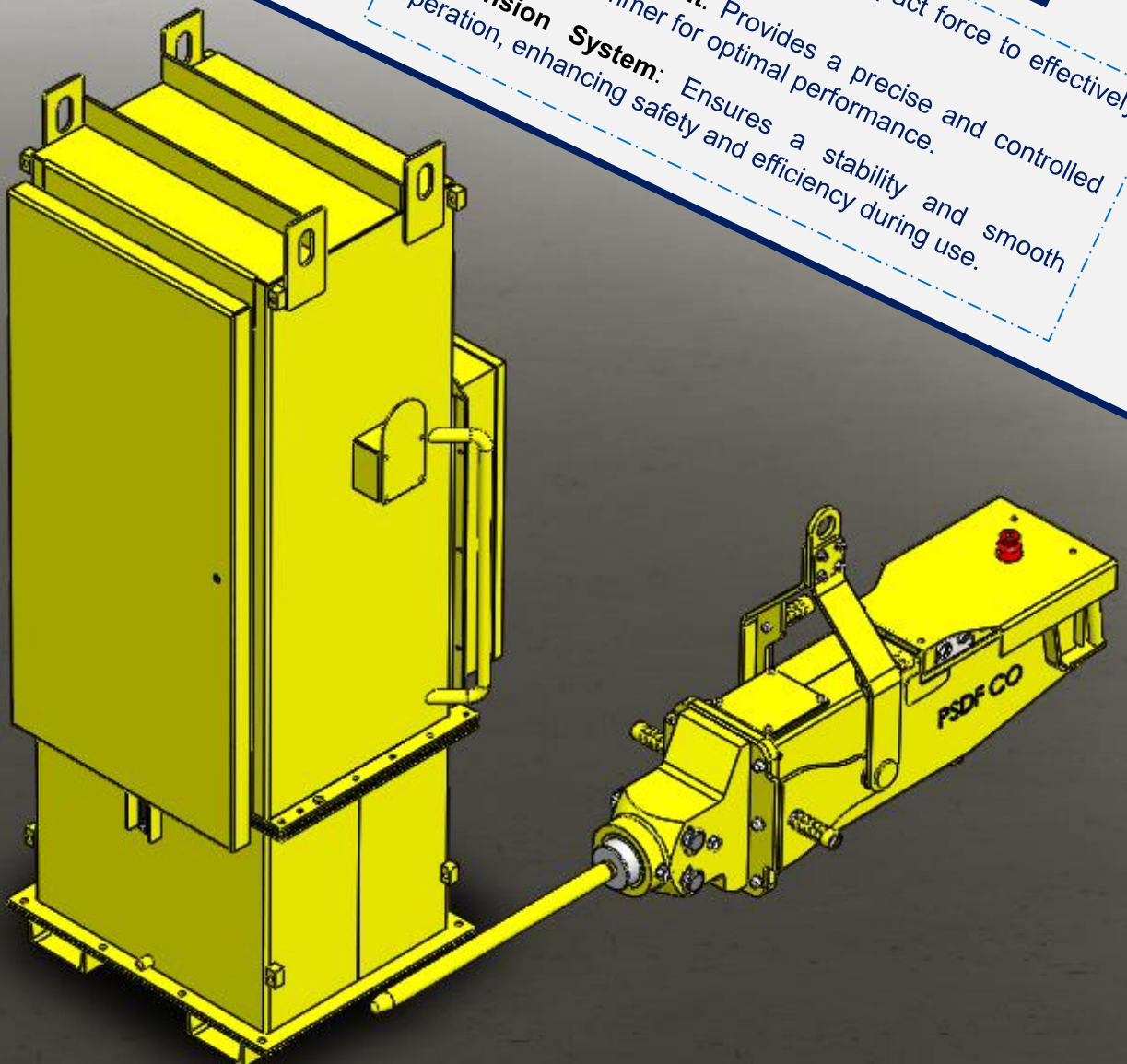

"Advanced Safety Features for Operator Protection and Reliability"



At PSDF, safety is paramount in our products we design. The Liner Bolt Removal Hammer is equipped with cutting-edge safety features, including:

- **Counterbalance Valves:** Maintain precise control during operation, ensuring stability.
- **Emergency Stop Buttons:** Allow for instant shutdown in critical situations.
- **Electrical Insulation:** Protects operators from electrical hazards.
- **Integrated Drain Valves:** Prevent fluid buildup in control valve sets, ensuring smooth operation.
- **Monitoring Tools:** Equipped with an RTD sensor, oil level indicator, temperature switch, and pressure gauges for real-time monitoring of operational conditions.



"Optional Features Offered by PSDF for Enhanced Performance and Safety"

To further optimize your operation, PSDF provides the following optional features:

- **Wireless Remote Control:** Enables improved flexibility and ease of operation.
- **Moil Guide:** Ensures easier and safer handling during liner bolt removal.
- **Monorail Suspension System:** Available in various capacities to adapt to your specific setup and requirements.

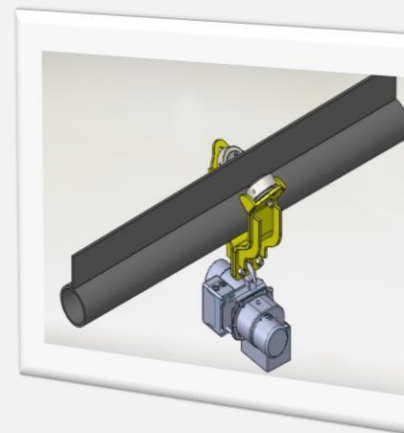

"Customizable Solutions for Your Specific Needs"

Our Liner Bolt Removal Hammers are fully customizable to match the unique requirements of your operation. Energy, frequency, and impact rates can be tailored to the customer specifications. With models offering impact energies ranging from **750 joules to 2000 joules**, PSDF ensures you have the perfect solution for your specific application.

Technical specifications

Item	Unit	Specification	Item	Unit	Specification
Manufacturer	-	PSDF	Power	kW	According to impact energy
Impact energy	Joules	750 - 2000	Voltage/frequency		400 V AC, 50 Hz
Hits per minute (Max.)	-	45 - 90	Jib degree of freedom	-	3

"Comprehensive Documentation for Seamless Integration and Maintenance"

To ensure smooth operation and maintenance, PSDF provides the following documentation to the clients:



- ❖ **Operation, Maintenance, and Installation Manual:** Detailed guidelines for optimal usage and upkeep.
- ❖ **Electric & Hydraulic Schematics:** Clear and precise diagrams for troubleshooting and system understanding.
- ❖ **VDDR (Vendor Drawings and Data Requirements):** Comprehensive technical drawings and data for seamless integration into your operations.



Safety of machinery – General principles for design and risk reduction	ISO 12100
Risk assessment – Practical guidance and examples of methods	ISO 14121-2
Safety of machinery – Design of safety-related parts of control systems	ISO 13849-1
Safety of machinery – Validation of safety-related parts of control systems	ISO 13849-2
Material standard	DIN, ASTM, and ISO
Welding	AWS D 1.1 and AWS D 14.1
Quality management	ISO 9001

Key Advantages



"Efficient Liner Bolt and Liner Removal to Minimize Downtime"

Experience swift and effective removal of tightly fastened liner bolts and liners, significantly reducing operational downtime and enhancing productivity.



"Extended Maintenance Intervals for Lower Operational Costs"

Benefit from reduced maintenance intervals, effectively lowering overall operational costs and maximizing equipment uptime.



"Simplified Maintenance with Easy Access Design"

Enjoy hassle-free maintenance with a design that provides easy access to key components, ensuring quicker servicing and minimized downtime.



"Enhanced Operator Safety with Ergonomic and Shock-Reduction Features"

Ensure maximum operator safety with an ergonomic design and advanced shock-reduction features, minimizing strain and improving overall handling during operation.

"No Impossible with Innovation"



Scan me!



Phone: (+98) 34 3246 6568
WhatsApp: (+98) 993 434 0301



psdfco.com



psdfco@gmail.com
info@psdfco.ir



[psdfco/linkedin](https://www.linkedin.com/company/psdfco/)



Main office address: Second Floor, Danesh Building, Science and Technology Park, Emam-Jomeh Boulevard, Kerman, Iran.



Factory location: PSDF Co., Tabatabaei 5, Sadid Industrial Zone, Entrance to Kerman-Zarand Road, Kerman, Iran.